

A Stadium of Green: The IU Arboretum

Walker Budwig-Scannell, Grant Culver, Eileen Jackson, and Lucas Moehle
School of Public and Environmental Affairs,
Indiana University, E422 Spring 2016



Introduction

The Arboretum is an 11 acre open area located off 10th street in the center of the Indiana University campus. By definition, an arboretum is a plot of land on which many different trees or shrubs are grown for study or display. The Arboretum plays a few roles within the IU campus: one which encourages learning and relaxation, a second which can contribute to urban canopy cover goals, and the last role is to create an environment that everyone on campus can enjoy.

While the Arboretum is an area of nature preservation and recreation, the area is lacking in its potential canopy cover. As IU begins its campaign to reach 40% canopy cover, the Arboretum represents an important area of potential canopy growth to jumpstart canopy growth throughout the campus.

Methods

We believe that the Arboretum has great potential to increase the canopy cover of that space, which will increase canopy cover across campus. Unfortunately increasing canopy cover at the Arboretum will not bring the campus canopy cover to 40% or frankly anywhere close. However, a strong Arboretum initiative that can be replicated to other areas of campus will provide a foundation for achieving 40%.

Results

Currently, the Arboretum is a large, open, grassy area that is largely used for pedestrian traffic and recreation. Within the Arboretum are a variety of tree species ranging from large Sycamores to small flowering Dogwoods.

The current state of the Arboretum is less than imagined when initially designed. The following map shows the design plans for the Arboretum in 1983:

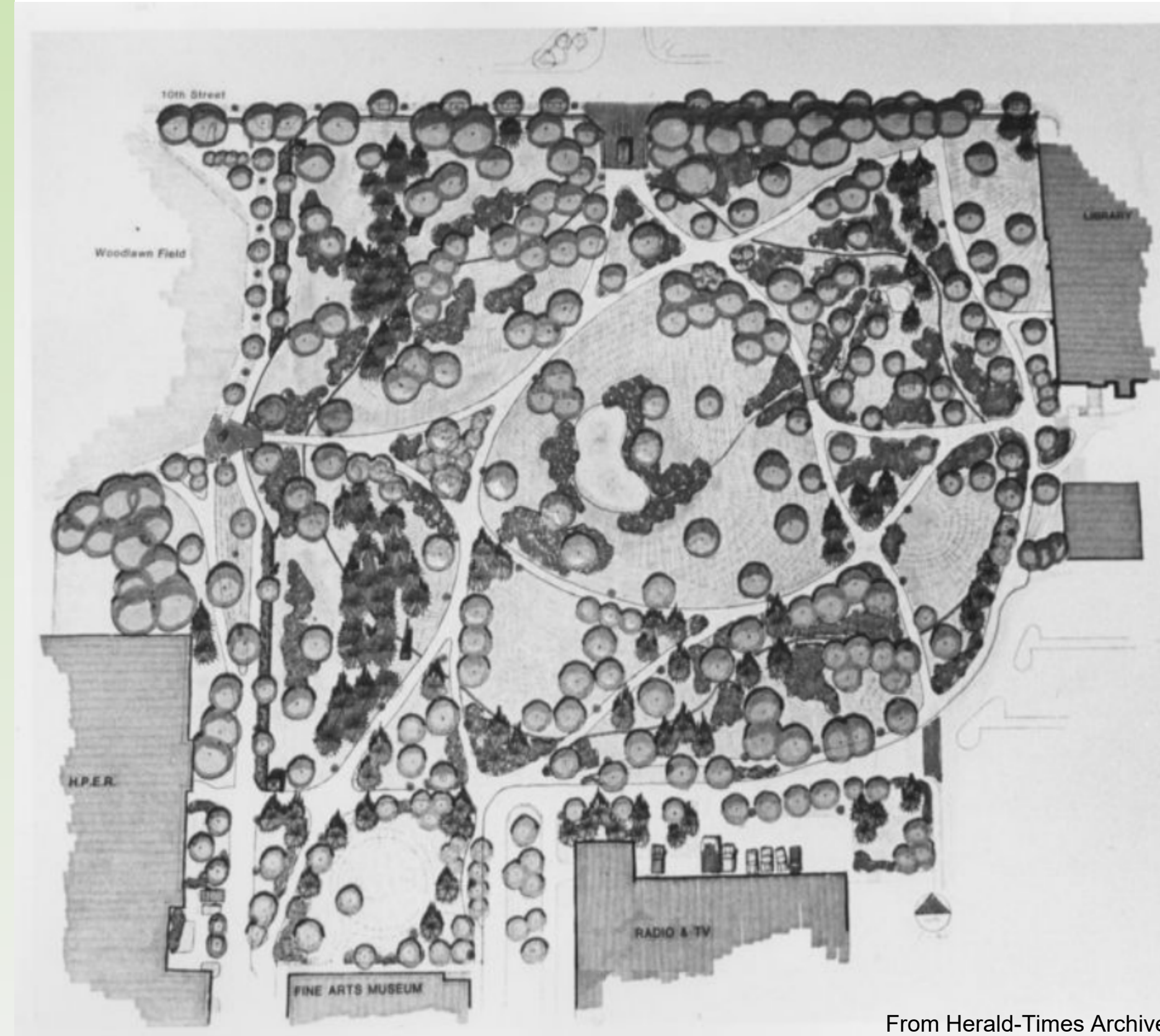

The Arboretum today has significantly less canopy than the initial plans indicated. If IU intends to reach the 40% canopy goal throughout the campus, then the Arboretum is a great starting point to increase canopy cover without additional designation of open space.

In order to increase canopy of the Arboretum, the following steps may be taken:

- Planting of deciduous trees with large canopies
- Reduced planting of smaller flowering trees
- Planting of water-friendly species near pond in center of Arboretum
- Plant more trees in non-utilized areas (corners, along fences, etc.)
- Because of the high variety of species in the area, develop and implement invasive species eradication plan

We recommend a goal canopy cover within the Arboretum to be **60%**, so that the recreational value of the area may remain while contributing to the overall canopy cover on campus.



This area is located in a corner of the Arboretum next to the library. This area has the potential to increase canopy and aesthetics.

Conclusions

While increasing canopy cover in the Arboretum won't singlehandedly allow IU to reach its UTC goals, there are a few reasons why it should be done:

- It is an easy opportunity to increase canopy growth
- It is very central to campus in a high-traffic area
- The Arboretum serve as a symbol of IU's continued commitment to the UTC goal, trees, and having a beautiful campus

An increase in Arboretum canopy cover cannot singlehandedly address the IU campus canopy cover, however it is an important step toward the building up of urban canopy on campus.

Literature cited

- Indiana University Master Plan, 2009. 21 Apr. 2016.
"IU through the Years: The Arboretum." *HeraldTimesOnline*. N.p., 12 Aug. 2014. Web. 21 Apr. 2016.
Mincey, Sarah, and Burney Fischer. "The Woodland Campus." IUB School of Public and Environmental, 2009. Web. 18 Apr. 2016.

Acknowledgments

For more information please feel free to contact any of the following contributors:
Grant Culver~ grculver@indiana.edu
Eileen Jackson~ eijacks@indiana.edu
Lucas Moehle~ lmoehle@indiana.edu
Walker Budwig-Scannell~ wfbudwig@indiana.edu

